

Dati tecnici:
Technical Data:

Pressione minima >2 bar
Minimum pressure >2 bar

Portata 0.5 L/min.
Flow 0.5 L/min.

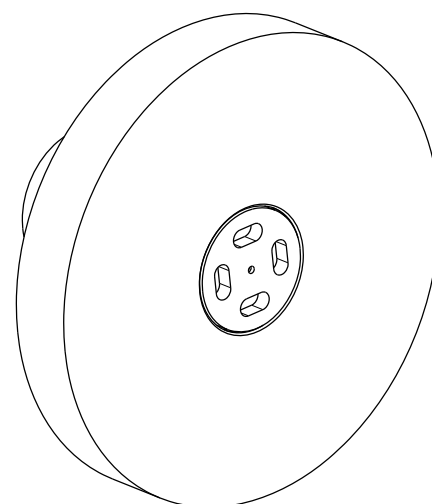

GESSI

Gessi Sp.A. Parco Gessi, 13037 Serravalle Sesia (Vercelli) Italy
Tel.0039 0163 454111 Fax.0039 0163 453150
www.gessi.com e-mail: gessi@gessi.it gennaio 2011 copyright © GESSI S.p.A.

- 32977

Nebulizzatore Ø65 a parete/soffitto

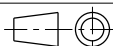

formato / size

A4

Rev.

0 R01

codice cliente / client code

Standard