



# ALESSANDRA

## POLISHED | SATIN

### STAINLESS STEEL

WARRANTY  
**10 YEARS**

#### MATERIAL:

- Vertical collectors in polished/satin stainless steel  $\varnothing$  30 mm.
- Horizontal elements in polished/satin stainless steel 30x10 mm.

#### FIXING KIT:

Brackets, airvent, hexagonal tool, plugs and screws for mounting suitable for use on compact or hollow brick, user notice.

The kit is certified from TÜV in compliance with VDI 6036 - class 4.

#### PACKAGING:

Carton angular and profiles protected by a recyclable film in polyethylene. User notice included.

#### FEATURES:

It is totally made in stainless steel with an unalterable finishing guaranteed during the years.

#### ACCESSORIES:

For the complete list, please refer to the accessories chapter.

#### AVAILABLE FUNCTIONS:

- Hot water
- Electric

P. Max: 8 bar

Functioning: hot water

T. Max: 110° C

Connections: n° 2 x 1/2" G - 1 x 1/2" G

## CERTIFICATES



## ACCESSORIES



#### Kristal valve square with thermostatic option chromed

Copper conn.  $\varnothing$  12/14/15  
Art. nr. 5991990311165

Multilayer conn.  $\varnothing$  16  
Art. nr. 5991990311166



#### Kristal corner valve with thermostatic option chromed

Copper conn.  $\varnothing$  12/14/15  
Art. nr. 5991990301148

Multilayer conn.  $\varnothing$  16  
Art. nr. 5991990301147



#### Thermostatic head chromed

(Kit 2 pieces)

Art. nr. 5035270710015

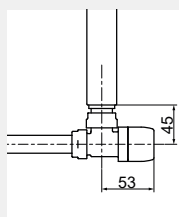

Quotes for square Kristal valves with thermostatic option

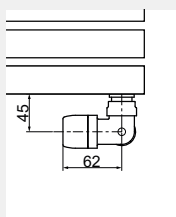

Quotes for corner Kristal valves with thermostatic option



#### Pair of polished tube cover kit

Art. nr. 5103000000061

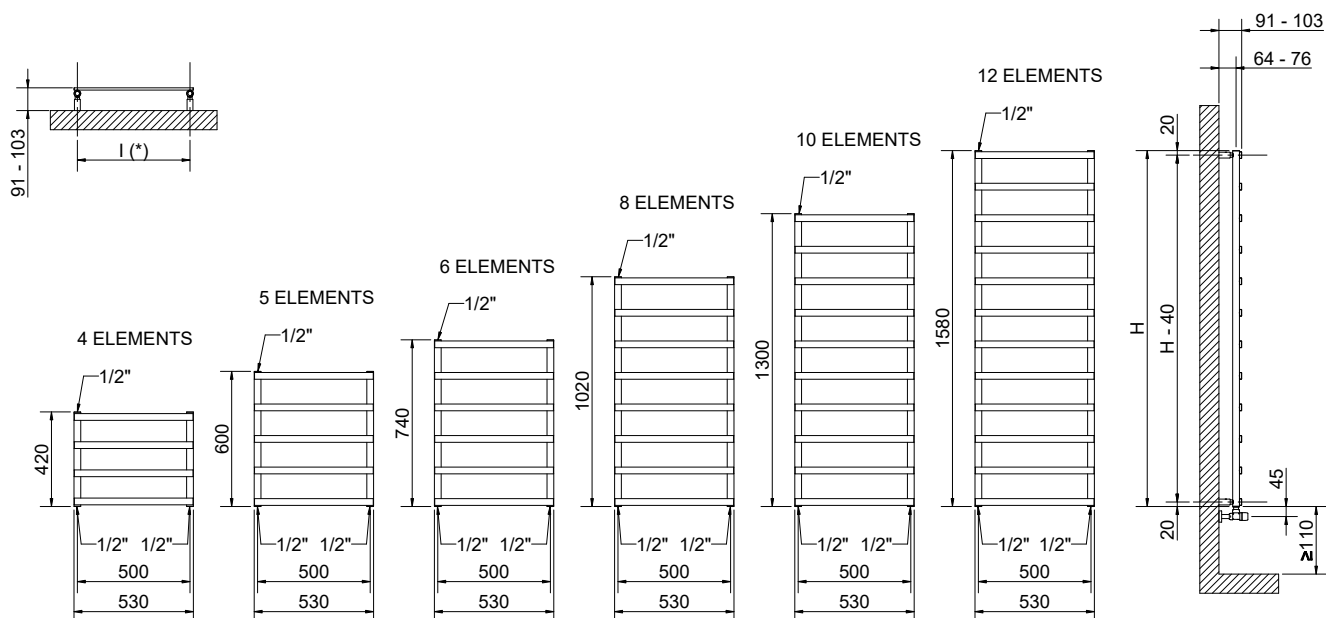

(\*) The fixing kit has the same pipe centre (l) as the radiator

Quotes for Kristal valves

### ALESSANDRA POLISHED STAINLESS STEEL

Thermal output  
[Watt]

Height [mm]	Width L [mm]	Pipe centres l [mm]	Art. nr.	Dry Weight [Kg]	Surface [m <sup>2</sup> ]	Water content [lt]	Δt=50°C	Δt=30°C	Exp. n
<b>420</b>	530	500	3551680400001	2,49	0,25	0,92	122	68	1,1437
<b>600</b>	530	500	3551680400002	3,25	0,32	1,24	152	85	1,1529
<b>740</b>	530	500	3551680400003	4,01	0,39	1,51	177	98	1,1601
<b>1020</b>	530	500	3551680400004	4,77	0,53	2,05	228	125	1,1814
<b>1300</b>	530	500	3551680400005	5,52	0,66	2,59	286	157	1,1804
<b>1580</b>	530	500	3551680400006	6,27	0,81	3,13	353	193	1,1795

For output at different ΔT, please refer to the following formula: desired output = output at ΔT 50 °C x (desired Δt/50)<sup>n</sup>

### ALESSANDRA SATIN STAINLESS STEEL

Thermal output  
[Watt]

Height [mm]	Width L [mm]	Pipe centres l [mm]	Art. nr.	Dry Weight [Kg]	Surface [m <sup>2</sup> ]	Water content [lt]	Δt=50°C	Δt=30°C	Exp. n
<b>420</b>	530	500	3551680450001	2,49	0,25	0,92	125	70	1,1923
<b>600</b>	530	500	3551680450002	3,25	0,32	1,24	164	92	1,1928
<b>740</b>	530	500	3551680450003	4,01	0,39	1,51	193	108	1,2357
<b>1020</b>	530	500	3551680450004	4,77	0,53	2,05	251	139	1,2751
<b>1300</b>	530	500	3551680450005	5,52	0,66	2,59	310	170	1,2873
<b>1580</b>	530	500	3551680450006	6,27	0,81	3,13	372	201	1,2945

For output at different ΔT, please refer to the following formula: desired output = output at Δt 50 °C x (desired Δt/50°C)<sup>n</sup>