

TIME

Built-in thermostatic with shut-off

Brushed Gold - 47 130 477

GRB mixers®

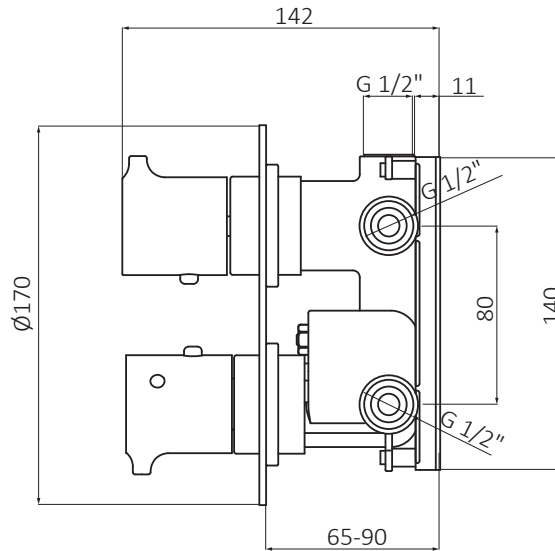
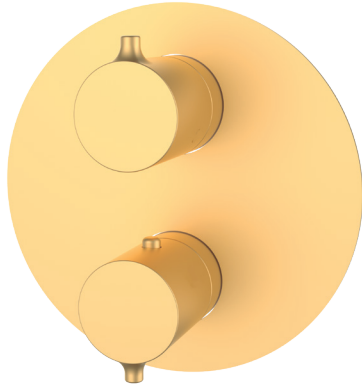

INTERNAL MECHANISM:

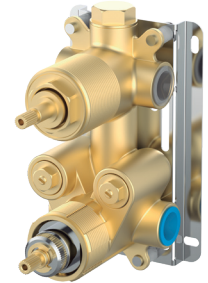

10

COLLECTION: **TIME** PRODUCT: **Built-in thermostatic with shut-off**

FINISH: **Brushed Gold** CODE: **47 130 477** EAN 13: **8435200299442**

PACKAGED PRODUCT INFORMATION: WEIGHT: **2.74 kg** WIDTH: **20 cm** LONG: **33.5 cm** HIGH: **9 cm**

LINK ASSEMBLY INSTRUCTIONS: http://d7rh5s3nxmpy4.cloudfront.net/CMP2592/files/041792_03_MAIL_Instrucciones_MonTerm_Empotrar_PARTE_EXTERNA.pdf

TECHNICAL SPECIFICATIONS:

- › RECOMMENDED PRESSURE: 1 to 5 bars
- › MAXIMUM PRESSURE OF USE: 10 bars
- › INLETS: (H) G 1/2"
- › OUTLETS: (H) G 1/2"
- › Diverter: In flow handle
- › Cartridge Thermostatic
- › Depth in wall min. 65 mm max. 90 mm
- › Do not use the outlets sealed with metal plugs
- › Metal sheet incorporated in the built-in mechanism. Dimensions: 73x140x10 mm
- › Sensitivity and acoustics according to the norm EN ISO 3822

MATERIAL SPECIFICATIONS:

- › Machined brass bodies
- › Ni base coating, brushing process and Au electrolytic bath
- › Metallic handle

USE SPECIFICATIONS:

- › Depth in wall min. 65 mm max 90 mm
- › Connections F 1/2"
- › GRB Live Technology, constant temperature. Valid for all hot water supplies
- › Without minimum pressure and without calibration
- › Anti-liming and self-calibrated metallic cartridge, certificated by Aenor
- › Water shut-off system for maintenance
- › Easy accessible filters and check valves

SPARE PARTS LIST:

- › 00010721: Time Male bath and shower flow handle
- › 00010723: Time Male temperature handle
- › 040102: Thermostatic cartridge
- › 040091: Diverter cartridge 3 ways
- › 00045702: Built-in thermostatic/mixer 2-3 ways plate
- › 00917107: Dust cover
- › 047039: Built-in thermostatics check valve